

# BELLA (PAN ONLY)

WELS Reg No: LM07853

WELS: 4 Star 3.5L Average Flush



## Hinge Covers



FRONT VIEW

SIDE VIEW

TOP VIEW

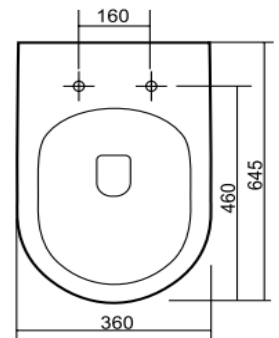
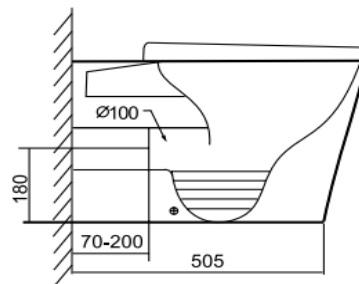
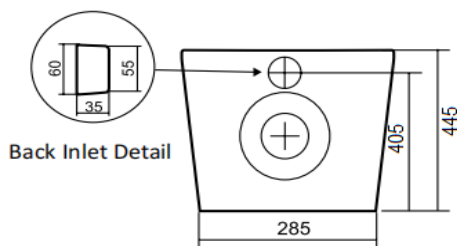

## SPECIFICATIONS

Suitable for S or P Trap

Square Flush Button in Chrome (Brushed Nickel, Brushed Brass, Gun Metal and Matte Black Flush Button and Hinges available at Additional Charge)

Dual Flush: 4.5L full flush and 3L half flush

Soft Closing Seat with Quick Release Button

Bottom Right Hand or Back Inlet Connection

Adjustable Floor Set Out: 100 - 200mm s-trap or 180mm p-trap

### WARRANTY INFORMATION:

15 years Replacement Parts or Complete Product

3 years Replacement for Toilet Valves

1 year Replacement for Seat, Hinges, Flush Pipes and Button

All products have a full 1 year in house labour warranty from date of purchase

**ZENIMO**  
Zen-inspired, Modern Living

**ADDRESS:** 42 Castro Way, Derrimut VIC 3026

**PHONE:** (03) 8390 6300

**OFFICE:** ect\_sales@outlook.com

**SERVICE:** ect\_service@outlook.com

**WEBSITE:** www.ectglobal.com.au